

**ETHICS**<sup>®</sup>

*of Caring*

**NNEC**

5<sup>th</sup> NATIONAL  
NURSING  
ETHICS  
CONFERENCE

25th Anniversary  
Reimagining Nursing from the Inside Out  
An Invitation to Reflect, Celebrate, Re-Imagine, and Transform

March 7-9, 2018  
UCLA Luskin Conference Center  
Los Angeles, CA

[www.ethicsofcaring.org](http://www.ethicsofcaring.org)

# Welcome & Description

## Welcome to Los Angeles!

Welcome to the 5th NNEC

As we gather in Los Angeles for the 5th National Nursing Ethics Conference, we will also be celebrating Ethics of Caring's® 25th anniversary and its many years of providing nursing ethics education. Your experience the next few days will stand on that foundation – a belief that clinical work requires developing an expertise in recognizing and responding to the moral questions that arise in healthcare. We are privileged to be able to do this together in community, to collectively learn from each other and creatively develop practical approaches to the ethical challenges we face.

The theme this year, “Reimagining Nursing from the Inside Out” speaks to the ethical practices of reflection and assessment, going within ourselves and our profession to understand our strengths and our needs. Then we can find ways to integrate our core values and innovatively evolve a personal and collective future for nursing that will stretch us to transform our practices, moral spaces, and work environments. We look forward to our time together with you. May the conference be restorative for each of you, so that you return to your practice with the gift of resiliency.

Warm regards,

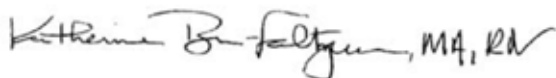

Katherine Brown-Saltzman, MA, RN  
Co-director, UCLA Health Ethics Center  
President, Ethics of Caring®  
Co-Chair, NNEC 2017 Planning Committee



Heather Fitzgerald, MS, RN  
Clinical Nurse Ethicist  
Children's Hospital Colorado  
Co-Chair, NNEC 2017 Planning Committee

## Conference Description

**Reimagining Nursing from the Inside Out** is the theme for the 5th Ethics of Caring® National Nursing Ethics Conference (NNEC). An Invitation to Reflect, Celebrate, Reimagine, and Transform. Calling all nurses and our colleagues. In our heart of hearts, we chose to work in healthcare professions quite literally to make the world a better place by helping those in need. We have all experienced the deep sense of fulfillment and joy that accompanies our being present, in competent and compassionate ways, at the most vulnerable times for our patients and their families. Many are finding it increasingly difficult to renew our energies for healing as we meet the dynamic and complex challenges of health care today.

Join national nursing ethics leaders as we reflect on and celebrate the best of nursing's historical commitment to the sick, suffering, and dying and reimagine the power of 21st century nursing unleashed in our troubled world. Think about these two days as an ethics retreat. We won't be handing out magic wands, but we can promise you precious time to reflect on our personal and collective commitments and to strategize about how best to create a positive future for nursing and the communities we serve. The journey begins with each us.

## Our commitment

NNEC is committed to providing an environment of learning that captures an ethic of care for healthcare professionals:

- welcoming participants of all backgrounds to create an environment that is respectful and inclusive
- healthy farm-to-table Californian cuisine - buffet breakfasts and lunches each day (built-in to registration fee)
- a beautiful environment surrounded by art and wellness practices
- one breakout session each day that allows for an immersion & depth of understanding in the topic of choice
- opportunity for discussion and practical guidance
- acknowledging excellence in ethics through the Nursing Ethics Leadership Award
- ending the day with a wine & hors d'oeuvre reception on the terrace

“It is the function of art to renew our perception.  
What we are

# Program Planning Committee

Katherine Brown-Saltzman,\* MA, RN (NNEC Co-Chair)  
UCLA Health  
President, Ethics of Caring®

Heather Fitzgerald, MS, RN (NNEC Co-chair)  
Children's Hospital Colorado

Brenda Barnum,\* RN, BSN, MA  
Children's Hospital Los Angeles

Jennifer L. Bartlett, PhD, RN-BC, CNE, CHSE  
Georgia Baptist College of Nursing  
Mercer University - Atlanta, Georgia

Elissa Brown,\* MSN, RN, PMHCNS-BC  
Vice-President, Ethics of Caring®

Janine-Mariz Burog, MSHA  
UCLA Health

Maureen Cavanagh, MS, MAHCM, RN, C-EFM  
St. Peter's Health Partner's – Albany, New York

Anna Dermenchyan,\* MSN, RN, CCRN-K  
UCLA Health

Theresa S. Drought,\* PhD, RN  
Kaiser Permanente, Woodland Hills Medical Center

Katherine DuBois, MSN, RN-BC  
Children's National Health System  
NW Washington, DC

Kathleen Feldman, MSN, RN  
UCLA Health

Rev. Timothy Godfrey, SJ, DNP, RN, PHCNS-BC  
University of San Francisco

Linda Gorman,\* MN, RN, CHPN, FPCN  
Secretary, Ethics of Caring®

Joan Henriksen, PhD, RN  
Mayo Clinic – Rochester, Minnesota

Angela Knackstedt, BSN, RN-BC  
Children's Mercy – Kansas City

Donna McKlindon, MSN, RN, PMHCNS-BC  
Children's Hospital of Philadelphia

Douglas P. Olsen, PhD, RN  
Michigan State University, College of Nursing

Karen Pavic-Zabinski,\* PhD, MSN, MBA, RN, MAMS  
Providence Health & Services, Southern California

Ellen Robinson, RN, PhD  
Massachusetts General Hospital

Carol Taylor, PhD, MSN, RN  
Georgetown University – Washington, DC

Mary K. Walton, MSN, MBE, RN  
Hospital of the University of Pennsylvania

\* Ethics of Caring® Board member



familiar with we cease to see.” - Anais Nin

# General Information

## Conference Hotel

UCLA Luskin Conference Center  
425 Westwood Plaza - Los Angeles, CA 90095  
(855) LCC-UCLA (522-8252)  
<http://luskinconferencecenter.ucla.edu/>  
Reserve your room by February 5, 2018 to lock-in the special discounted group rate, use GROUP CODE: 180307NN  
Please note: no additional taxes on room, as rate is a complete fee.

## Parking

**Parking Structure 8** - Access to Luskin via bridge Level 3

**Day Parking** - Level 3 - \$12 cash

Attendants 6:00-8:00 AM to purchase permit

Credit card available Level 4 Pay Station

After 8 AM go to Parking Kiosk on Westwood Blvd

**Overnight Parking** - Parking Structure 8 Level 4 Pay Station

Arriving 3/07 select 2 night option \$48/ valid 8 PM 3/09

Arriving 3/08 select 1 night option \$24/ valid 8 PM 3/09

## Registration

Wednesday, March 7th 3– 5pm, Prodigy Room, 2nd floor  
Thursday, March 8th begins 6 am, Centennial Ballroom 1st floor  
Friday, March 9th begins 6:15 am, Centennial Ballroom 1st floor

## Conference Meals

Full Breakfast Buffet: Thursday and Friday  
Lunch Buffet: Thursday and Friday, join us on the Centennial Terrace

## Breakout Rooms, 2<sup>nd</sup> floor

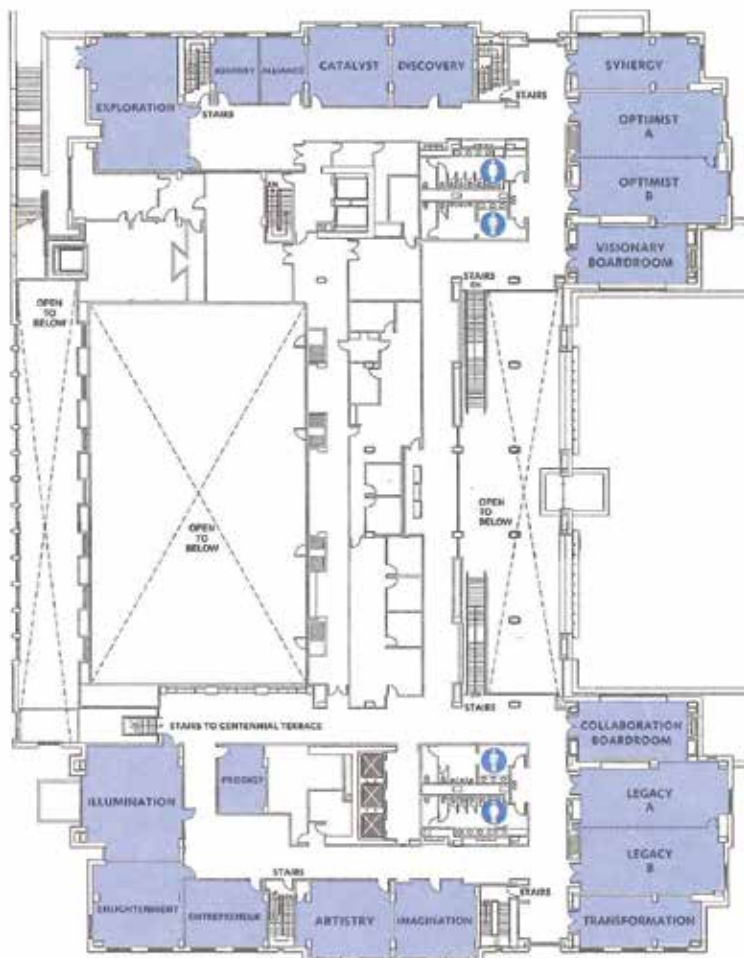

## Continuing Education Guidelines

UCLA Health is accredited as a provider of continuing nursing education by the American Nurses Credentialing Centers Commission on Accreditation. Nurses will be awarded 8.25 ANCC contact hours for participation in 1-day of the conference or 16.5 ANCC contact hours for participation in 2-days of the conference.

Provider approved by the California Board of Registered Nursing, Provider Number 12511 for 9.5 contact hours for participation in 1-day of the conference or 19.5 contact hours for participation in 2-days of the conference.

## Conference Objectives

1. Explore methods to maintain balance and resiliency as practicing nurses in healthcare.
2. Describe concrete ways to speak up individually and collectively as a profession to create an ethical environment.
3. Value the power of narratives in articulating the challenges associated with shaping the ethical environment in healthcare.
4. Analyze situations that illustrate an ethical response in cases where capacity is a factor and the practical application of a toolkit for addressing concepts associated with physician assisted death.
5. Identify actions that support the professional standards of nursing and ethically-grounded care.
6. Reflect on known and emerging ethical challenges such as end-of-life care, assisted suicide, and the introduction of innovative therapies and technology.

## Successful Completion

To receive contact hours for this learning activity, a participant must:

- Be registered for the activity & pay any required fees
- Be present no later than 5 minutes from the start of the learning activity & attend the entire learning activity
- Complete and electronically submit the session and program evaluation forms

## Evaluations & Awarding of Contact Hours

Electronic evaluations and contact hour certificates will be emailed to participants a few days following the conference. Please be mindful to check spam folders to ensure you do not miss the email.

## Conflicts of Interest

The planners and presenter(s)/author(s) of this CE activity have disclosed all relevant financial, professional, or personal relationships with any commercial companies pertaining to this activity. When a potential conflict of interest exists, it will be disclosed at the beginning of the individual session.

# Faculty

**Katherine Brown-Saltzman, MA, RN**, is the Co-Director and co-founder of the UCLA Health Ethics Center and an Assistant Clinical Professor at the UCLA School of Nursing. She received her BSN from Marquette University and her MA from Lesley College. Since 1975, her clinical practice has been in end-of-life care, with her work now focusing on ethics. She has been active in developing interdisciplinary programs on sustaining self-care, moral distress, and ethics education, including a clinical ethics fellowship. She has been a co-investigator in ethics grants from AACN, ONS, Sigma Theta, was part of an NIH grant developing end of life education for medical students, as well as a PCORI grant on advocacy. Her most recent area of research is centered on early indicators and risk factors in ethical issues. She is a member of three ethics committees and Co-chairs the UCLA Medical Center's Ethics Committee. She lectures nationally and internationally, has developed ethics and end of life care policies and has published on such diverse topics as, ethics, professional self-care, end-of-life care, bereavement, spirituality, psychosocial care, guided imagery and cultural issues.



**Maureen A. Cavanagh RN, MS, MA, D.BE**, is a Registered Nurse with over 20 years' experience in Advanced Practice Roles. She received her BS and MS in Nursing from Russell Sage College in Troy, NY as well as a Master's Degree in Health Care Mission at Aquinas Institute of Theology in St. Louis, Mo. She completed a doctorate in Bioethics at Loyola University, Chicago in 2014. Maureen is currently the Manager of Ethics Services for St. Peter's Health Partners in Albany where she co-chairs 2 Ethics Committees, provides multi-disciplinary education and ethics case consultation. She is also a former member of the Ethics Committee at the Teresian House in Albany. She has taught Healthcare Ethics for Maria College in Albany, NY, Excelsior College and is on the faculty of the Avila Gerontology Institute. Her research on the experience of Moral Distress in nurses has been presented nationally and she has published several ethics articles in the healthcare literature.

**Anna Dermenchyan, MSN, RN, CCRN-K**, is a Senior Clinical Quality Specialist in the Department of Medicine at UCLA Health and a 3rd year PhD student at the UCLA School of Nursing. Anna started her nursing career in the Cardiothoracic ICU at the Ronald Reagan UCLA Medical Center where she cared for the transplant and surgical patient population for five years. Currently, Anna leads, and implements improvement initiatives in the areas of hospital readmissions, mortality reduction, and population health management. Her research interest includes evaluation of self-management support programs for heart failure patients. Her professional interests include leadership, health care ethics and policy, quality and patient safety, critical care, and global health. Anna has presented locally, nationally, and internationally on clinical, professional development, and networking topics.



**Heather Fitzgerald, MS, RN**, is the Clinical Nurse Ethicist at Children's Hospital Colorado. Her clinical background is in the neonatal intensive care unit. Participation in both unit-based and hospital-wide ethics committees at Children's Hospital Colorado led to a Master's of Science in Healthcare Ethics. Prior to her nursing career, Heather produced theatre for 17 years, providing a balanced background in both the humanities and the sciences. This supports her well in ethics education, consultation and policy review and development in clinical settings throughout the hospital system. Heather co-chairs the Ethics Committee and chairs the Ethics Liaisons Committee at Children's Colorado. She is a member of the ethics faculty for the Center for Bioethics and Humanities at the University of Colorado. Heather frequently speaks regionally and nationally on ethical issues in the care of pediatric patients and their families.

**Ann Gallagher, PhD, RN**, is Professor of Ethics and Care, International Care Ethics Observatory, University of Surrey, UK & Fulbright Scholar-in-Residence, Tuskegee University, USA - Ann comes from Donegal in the west of Ireland and trained as a general nurse at the Royal Victoria Hospital in Belfast during 'the Troubles'. She then moved to England to take a post-registration qualification in mental health nursing. Following practice experience in elder care and adolescent psychiatry, Ann completed a degree in philosophy and health studies in London and went on to complete post-graduate qualifications in applied ethics in Wales. Her PhD study on the theme of 'Professional education and virtue ethics' was supervised by Professor Ruth Chadwick. Ann has published on, and researched, a wide range of topics relating to ethics and care, for example, on dignity in care, compassion in the NHS, professional regulation, professionalism in paramedic practice, love in professional life, slow ethics and ethics education (<https://www.surrey.ac.uk/fhms/research/centres/ICE/research/RIPE%20Project/>). She is Editor of the international journal Nursing Ethics (<http://journals.sagepub.com/home/nej>) and a member of the Nuffield Council on Bioethics. Ann is co-chair of a hospice ethics committee and chair of her university's Animal Ethics and Welfare Board. She is currently on sabbatical from the University of Surrey and exploring cross-cultural perspectives on ethics and elder care.



# Faculty



**Ann Hamric, PhD, RN, FAAN**, is a retired Professor and former Associate Dean for Academic Programs at Virginia Commonwealth University School of Nursing in Richmond, Virginia. She graduated from Vanderbilt University (BSN), the University of California at San Francisco (MS), and the University of Maryland at Baltimore (PhD). She has two areas of scholarship: advanced practice nursing and ethics and is editor of seven books; five on advanced practice nursing and two on the CNS role. Dr. Hamric has served on five ethics committees beginning in 1975, and currently is a member of VCU Health System's Ethics Committee. She has developed and taught ethics courses at all levels and has worked with inter-professional teams to develop courses and study research ethics. Her research has focused on moral distress, including the first quantitative study of moral distress in physicians. In 2008, she was awarded the "Substantive Contribution to Nursing Ethics" from the ASBH Affinity Group for Nursing. She is currently the co-Chair of the Bioethics Expert Panel of the American Academy of Nursing.

**Angela Knackstedt, BSN, RN-BC**, is the Health Literacy/Bioethics Clinical Coordinator at Children's Mercy Kansas City, a major academic medical center serving children Missouri and Kansas. Her nursing career has had a focus on nursing professional staff development, bioethics, health literacy, pediatric oncology, injury prevention and advocacy. In her current bioethics role she is the co-director and faculty for the Children's Mercy Certificate Program in Pediatric Bioethics, a 9-month online certificate program and is also the director of the program's Nurse Leadership Program that works with nurses to develop or expand nursing ethics at their institutions. She co-chairs the Children's Mercy Nursing Ethics Forum which is the voice of nursing in ethics throughout the organization and active member of the organization's Ethics Committee and ethics activities in the Kansas City metro area. Her work with community organizations, including chair-elect for board of Kansas Action for Children, has expanded her work and interest in the areas of health policy ethics and social determinants of health.



**Mark Lazenby, PhD, APRN, FAAN**, is an Associate Professor of Nursing and an Associate Professor of Religion and Health at Yale University. Mark Lazenby explores how nursing practice addresses some of life's biggest questions. He does this through the unique lens of being an advanced practice cancer nurse (MSN, Yale) and a philosopher of religion (PhD, Boston University). One such question is how to be a good nurse and a good person. In *Caring Matters Most*, Lazenby explores the ethical nature of daily nursing practice. He examines in the book how individual nurses can develop this moral character in themselves. As a cancer nurse, Lazenby is interested in helping patients with a cancer diagnosis deal with the questions of mortality. When he is not writing books, short essays, or blog posts, he is developing a palliative care intervention for Muslim patients who are in treatment for advanced cancer in the United States, a study funded by the American Cancer Society. He has co-edited *Safe Passage: A Global Spiritual Sourcebook for Care at the End of Life*, has worked with colleagues to develop the End-of-Life Professional Caregiver Survey, and is a co-investigator for the National Cancer Institute-funded Screening for Psychosocial Distress Program. At YSN, he teaches ethics to DNP students, philosophy of science to PhD students, and works with colleagues in the MSN oncology concentration. He is also Core Faculty on the Council on Middle East Studies and Fellow of Silliman College.

**Christine Mitchell, RN, MS, MTS, FAAN**, received a BA and MS in Nursing from Boston University, as well as a Master's degree from Harvard where she majored in philosophical and religious ethics as a Kennedy Fellow in Medical Ethics. Christine founded the clinical ethics program at Boston Children's Hospital, directing the ethics consultation service and leading the Ethics Advisory Committee for 30 years. In 2014, Christine became Executive Director and of the new Center for Bioethics at Harvard Medical School. Christine has served on numerous national committees, including the American Society for Bioethics and Humanities' Clinical Ethics Consultation Committee, the Ethics Committee for the American College of Obstetricians and Gynecologists and the Ethics Management team for the European Human Brain Project. Her publications include a series of ethics cases for *The Journal of Clinical Ethics*, articles for the *American Journal of Nursing*, *The New England Journal of Medicine*, the *Hastings Center Report*, and *Newsweek*, along with several documentary films, including "Code Gray" which was nominated for an Academy Award.



**Meg Moorman, PhD, RN, WHNP-BC**, is a Clinical Assistant Professor at Indiana University School of Nursing and Coordinator of the Masters in Nursing Education Track. She graduated from Indiana University with her BSN in Nursing, then earned her MSN and Women's Health NP degree from Drexel University. She earned her PhD in Nursing from University of Nevada Las Vegas. She has contributed to 6 books, including the book, *Reflective Organizations*, which received an American Journal of Nursing Book Award, has authored several articles on the use of art and specifically Visual Thinking Strategies (VTS) in nursing education, and has taught extensively in the undergraduate and graduate courses at IU. Dr. Moorman has presented her research on VTS internationally in Hong Kong, South African, and Ireland and is currently working with faculty from University Cork College in Ireland on a joint research endeavor. She serves as a reviewer for several peer-reviewed journals and works with a variety of faculty in nursing and medicine to promote the use of VTS in education.

**Ellen M. Robinson, PhD, RN**, has her MS and PhD in Nursing from the William F. Connell School of Nursing. Her dissertation, entitled 'Surrogate Experience in Living Through End of Life Decisions for Their Loved Ones with Advanced Dementia' received NINR National Science Research Award. Ellen completed an Ethics fellowship at Harvard, after which she transitioned to Nurse Ethicist at Massachusetts General Hospital (MGH). Ellen provides ethics consultation to health professionals, patients and families at the MGH. She serves on the MGH Hospital for Children Pediatric Ethics Committee and the Harvard Division of Medical Ethics Leadership Council. Ellen received a HRSA, Bureau of Nursing grant to develop and implement a Clinical Ethics Residency for Nurses, which mentored practicing staff and advance practice nurses in the process of ethics consultation. She is faculty at the Center for Bioethics at Harvard Medical School, and the schools of nursing at MGH and Boston College. Ellen's research focus is on the impact of ethics consultation on end of life conflict.



**Liz Stokes JD, MA, RN**, is a Senior Policy Advisor for the American Nurses Association Center for Ethics and Human Rights. She completed her BSN at the University of Virginia and worked several years as a critical care nurse. Liz received her Juris Doctor from the University of Richmond and worked as a Consultant for the D.C. Board of Nursing interpreting and conferring professional ethics provisions in nursing. She recently completed her Masters in Bioethics from Loyola University Chicago. Her leadership is also demonstrated through various charitable roles in the health and legal communities. She is a member of The American Association of Nurse Attorneys and serves on the board of the American Society for Bioethics and Humanities Affinity Group for Nursing. Liz also serves as an Associate Editor for the Journal of Bioethical Inquiry and is an active volunteer with the District of Columbia Bar Association. Liz is currently an American Academy of Nursing Jonas Health Policy Scholar.

**Carol Taylor, PhD, MSN, RN**, is a senior research scholar in the Kennedy Institute of Ethics at Georgetown University and a Professor of Nursing. Carol teaches in the undergraduate nursing program, directs a practicum in clinical ethics for graduate students in the philosophy program, serves on the ethics committee, conducts ethics rounds, and develops professional seminars in clinical ethics for health care professionals and the public. Her research interests include clinical and professional ethics, and organizational integrity. Carol has a PhD from Georgetown University and a Master's Degree in Medical-Surgical Nursing from Catholic University; she works closely with health care professionals and leaders who are exploring the ethical dimensions of their practice. A frequent international writer and speaker, she serves as an ethics consultant to systems and professional organizations. Carol has authored *Fundamentals of Nursing: The Art and Science of Nursing Care and Health and Human Flourishing: Religion, Medicine and Moral Anthropology and Case Studies in Nursing Ethics*.



**Karen Trotochaud, MN, MA, RN**, is the Nurse Ethicist for Children's Healthcare of Atlanta. She graduated from Georgia State University (BSN) and Emory University (MN). She also holds an MA in Bioethics and Health Policy from Loyola University Chicago. Her clinical nursing work has largely been in Neonatal Intensive Care. Since 1986 she has been a member of several institutional Ethics Committees and she is currently Co-Chair of the Children's Healthcare of Atlanta Bioethics Committee. For 10 years, she was at the Emory University Center for Ethics where she coordinated educational programming for Ethics Committee across the state and conducted research and education on pediatric palliative care. In her current position as Nurse Ethicist at Children's developed and coordinates the Ethics Liaison Program as well as providing system-wide ethics educational and policy support on ethical issues. Her current interests include interventions to address provider moral distress, nursing ethics education, and ethics case consultation.

**Lucia D. Wocial, PhD, RN, FAAN**, is the nurse ethicist and is part of the faculty for the clinical ethics fellowship at the Fairbanks Center for Medical Ethics (FCME) at Indiana University Health in Indianapolis, Indiana. She is the director for the Woltman Inter-professional Communication Project at the Indiana University School of Nursing where she is an adjunct assistant professor. She practiced in neonatal intensive care for more than 20 years both as a staff nurse and a certified clinical nurse specialist. Her current clinical practice is ethics. She has led the Unit Based Ethics Conversation (UBEC) program through FCME for the past ten years. She co-chairs the ethics consultation service sub-committee and is an active member of the ethics consultation service at Indiana University Health in Indianapolis. She served on the ANA task force that revised the Code of Ethics for Nurses in 2015. Her current research focuses on moral distress of professional caregivers, with a particular interest on clinicians who practice in the in-patient setting.



# Schedule

## Day 1 March 7, 2018

7:00pm-9:00pm **Evening Poster Session**  
Pinnacle, Odyssey, Pathways, and Innovation • 1st Floor

## Day 2 March 8, 2018 Reimagining the Vision

6:00-7:00 **Wellness Option: Campus Guided Walk (Optional)** • Hotel Lobby

6:00-8:00 **Registration** • Centennial Hall • 1st Floor

6:15-7:45 **Breakfast Buffet** • Centennial Hall • 1st Floor

7:45-8:00 **Welcome** • Centennial Ballroom • Katherine Brown-Saltzman

8:00-9:30 **001 • Keynote • Creating Moral Space**  
Centennial Ballroom  
Ann Hamric

**Description:** Using Margaret Urban Walker's reflections on moral space, we will identify strategies to identify, embed, and sustain moral space in your practice setting. This session promotes exploration of how moral space relates to your current, everyday practice.

9:30-10:00 **Break • Refreshments Served** • Centennial Hall • 1st Floor

**Poster viewing** • Pinnacle, Odyssey, Pathways, and Innovation • 1st Floor

10:00-11:15 **002 • Plenary • Using Art to Develop Ethical Competence: Visual Thinking Strategies**  
Centennial Ballroom  
Meg Moorman

**Description:** Have you ever had a piece of art speak to you? Did it inspire you to see things differently? Come engage in this interactive session on visual thinking strategies (VTS) designed to focus your attention on perspectives related to the development of ethical competence.

11:15-11:30 **Break • Refreshments Served** • Centennial Hall • 1st Floor

11:30-12:45 **003 • Case Discussion One: Developing our Moral Imagination . . .  
Envisioning the Possibilities**

2nd Floor Breakout Rooms (same as afternoon breakout session locations)  
All faculty and planning committee members

**Description:** Frame Change is an innovative card game designed to develop moral imagination in healthcare professionals. The game leads players through considering other moral viewpoints and alternative ways to respond in ethical situations.

**Objectives:**

- Define moral imagination.
- Defend a stance based on perspectives that may not be yours.
- Identify situations that might benefit from using moral imagination.

12:45-1:45 **Lunch** • Alfresco on the Centennial Terrace • 3rd floor



**1:45-3:30 Breakout sessions • 2nd Floor**

**004 • Strategies to Sustain Ethical Elder Care**

ROOM TBA • **Ann Gallagher**

**Description:** This session focuses on the RIPE project, a special project designed to research interventions that promote ethics in social care. This engaging session will immerse you in the perspective of the caregivers and the elders in residential settings. We look forward to comparing your experiences to responses gained through the RIPE project.

**005 • The Circle of Life & Death: Transforming Both our Patients and Ourselves**

ROOM TBA • **Meg Moorman and Maureen Cavanaugh**

**Description:** When birth and death coincide, the challenge of caregiving exposes the vulnerabilities of both providers and patient. It can be either a crushing or a transformational moment. During this session through the use of visual thinking strategies and case analysis, you will explore the caregiver's ability to embrace patient values that at first seem at odds with the healthcare team; moving from adversary to advocate.

**006 • Caring Matters Most: The Ethical Significance of Cancer Nursing**

ROOM TBA • **Mark Lazenby**

**Description:** What are the moral habits of cancer nurses? How do these habits relate to a principalist or ethics of caring approach to ethics? Join the group in a session designed to stimulate conversation about the habits of a moral nurse within the context of cancer nursing.

**007 • Looking Inward and Amongst Colleagues as a Strategy to Enhance Professional Caregiving**

ROOM TBA • **Ellen Robinson**

**Description:** This session will provide an opportunity for clinical nurses to recognize the influence that personal values may have in managing complex patient cases. Come join us as we create space for reflection and identify strategies designed to balance delivering compassionate care and self-protection.

**008 • Health Equity and Disparity**

ROOM TBA • **Carol Taylor**

**Description:** Come discuss the fact that health disparities have wide impact on nurses as individuals and as members of a profession. Let's work to identify ways you can impact change. This session facilitates your ability to relate what is happening in our local, national, and global societies to how we treat one another in health care.

**009 • A Call to Action: Exploring Moral Resilience**

ROOM TBA • **Liz Stokes**

**Description:** The American Nurses Association recently released a report, A Call to Action: Exploring Moral Resilience Toward a Culture of Ethical Practice. Let's explore strengthening moral resilience together. Then let's take it step further and identify recommendations for nurses, nurse leaders, and organizations for how to improve patient outcomes by establishing ethical practice settings.

**010 • Clinical Ethics Dilemmas in Pediatrics: Why These Cases May Haunt You**

ROOM TBA • **Lucia Wocial**

**Description:** Pediatric cases can be particularly challenging for nurses. Join us as we explore essential ethical concepts and describe a practical approach to addressing these multifaceted cases. We'll also explore the value of narrative inquiry when facing these dilemmas.

**3:30-3:45 Break • Refreshments Served • Centennial Hall • 1st Floor**

**Poster viewing • Pinnacle, Odyssey, Pathways, and Innovation • 1st Floor**

# Schedule

## Day 2 March 8, 2018 (Continued)

### 3:45-4:45 011 • Closing • Caring is the Greatest Thing: Caring Matters Most

Centennial Ballroom

Mark Lazenby

**Description:** The development of moral habits is foundational to cultivating the moral character of the profession of nursing. Come explore the connections between an individual nurse developing a moral habit, the moral character of nursing, and the development of a good society.

### 4:45-5:30 012 • Recognizing a Nursing Ethics Leader: A Conversation with Christine Mitchell

Centennial Ballroom

Christine Mitchell & Katherine Brown-Saltzman

**Description:** This special interview will showcase the expertise and experience of an exemplary nursing ethics leader, Christine Mitchell. In 1984, Christine recognized the ethical dilemmas facing nurses and helped to produce a visionary documentary Code Gray. Since that time she has worked on so many levels to improve how nurses and others address moral concerns, from education, to policy work, to engaging in ethics consultation, and publishing. Christine takes her passion and thinks outside the box as is demonstrated by the development of an all-volunteer citizen Community Ethics Committee for informed public input on ethical aspects of health care and health policies. Her insight will inspire nurses to move from hindrance to passion and action.

### 5:30-6:45 Award Reception • Centennial Terrace • 3rd Floor

Poster Viewing • Pinnacle, Odyssey, Pathways, and Innovation • 1st Floor

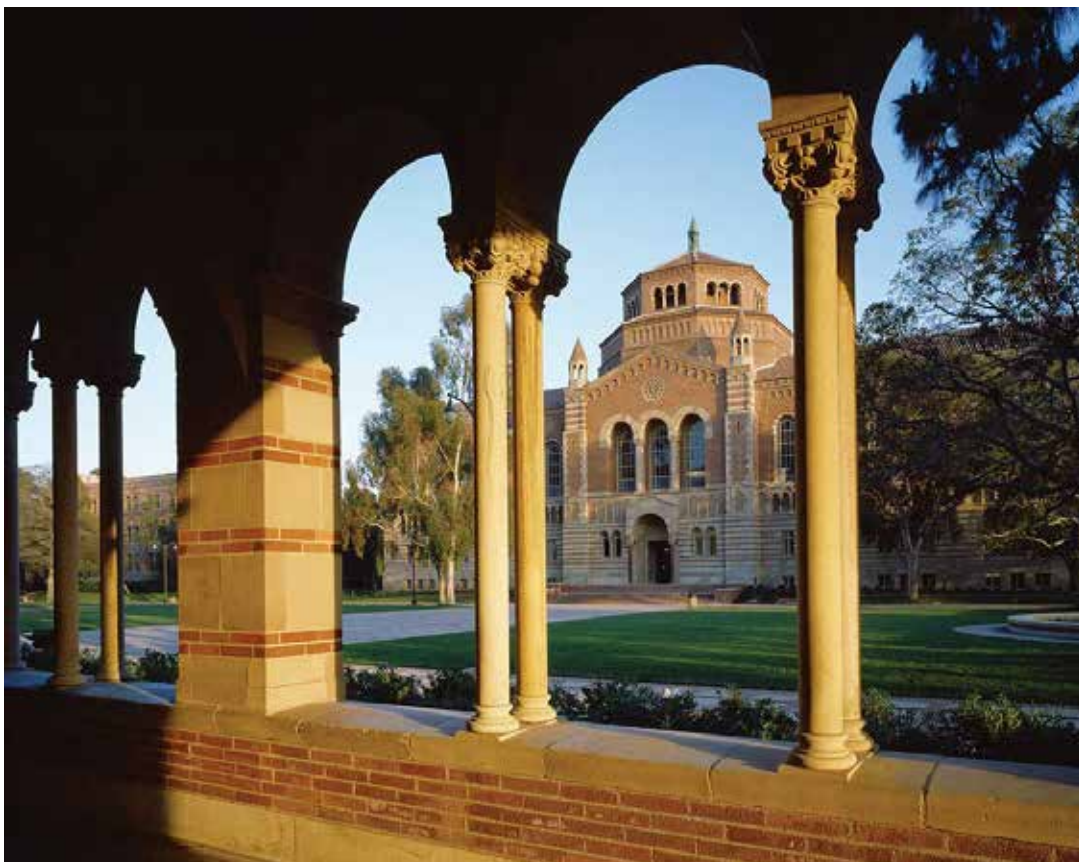

## Day 3

### March 9, 2018 Realizing and Enacting the Vision

6:00-7:00

Wellness Option: Yoga (Optional) • Legacy A & B

6:15-7:45

Registration and Breakfast Buffet • Centennial Hallway

Poster Viewing (No presenters available) • Pinnacle, Odyssey, Pathways, & Innovation • 1st Floor

7:45-8:00

Welcome • Centennial Ballroom • Heather Fitzgerald

8:00-9:15

013 • Keynote • Transforming Moral Outrage and Moral Resignation into Moral Action  
Centennial Ballroom  
Carol Taylor

**Description:** You have the power! Let's celebrate our individual and collective moral agency as we explore historical and current perspectives on advocating for our vulnerable patients.

9:15-9:45

Break • Refreshments Served • Centennial Hall • 1st Floor

Poster viewing • Pinnacle, Odyssey, Pathways, and Innovation • 1st Floor

9:45-11:00

014 • Plenary • Strategies to Enhance Moral Agency and Advocacy  
Centennial Ballroom

Karen Trotochaud, Lucia Wocial, Anna Dermenchyan, Angela Knackstedt, & Liz Stokes

**Description:** This interactive panel session is designed for each of us to look at ways in which we can support the moral agency of the nurses within our organizations. We will compare the different methods that can be utilized and begin to identify on a personal level what we can do to get nursing voices and values heard within our own work environments, out into the community and beyond.

11:00-11:15

Break • Refreshments Served • Centennial Hall • 1st Floor

11:15-12:15

015 • Case Discussion Two: Learning Through Our Stories: Moving into Action  
2nd Floor Breakout Rooms

(same as afternoon breakout session locations)

All faculty and planning committee members

**Description:** Join us for this session designed to provide a space to share your stories, your hopes, your dreams, your fears, and your successes as we look to explore our nursing practice. Standing still can indeed weary us - this is an opportunity to create simple actions and movement that help us become the change.

**Objectives:**

- Explore together the deepest meaning of our collective and individual nursing practice.
- Identify three actions steps or leadership strategies to implement in my practice or environment.

12:15-1:15

Lunch Buffett • Al fresco on the Centennial Terrace



photo credit: Reed Hutchinson

# Schedule

## Day 3      March 9, 2018 (Continued)

1:15-3:00      Breakout sessions • 2nd Floor

**004 • Strategies to Sustain Ethical Elder Care**

ROOM TBA • **Ann Gallagher**

**Description:** This session focuses on the RIPE project, a special project designed to research interventions that promote ethics in social care. This engaging session will immerse you in the perspective of the caregivers and the elders in residential settings. We look forward to comparing your experiences to responses gained through the RIPE project.

**016 • Ethics Champion Workshop**

ROOM TBA • **Angela Knackstedt, Karen Trotochaud, & Heather Fitzgerald**

**Description:** Come and explore the different approaches that have been taken in implementing successful ethics champion programs. Ethics Nurse Leaders from a variety of institutions will share with us the strategies they used to implement and sustain their programs. Begin to develop approaches that will be a good fit for your workplace and identify actions that you can do to get started.

**017 • Advocacy Beyond the Bedside**

ROOM TBA • **Liz Stokes & Anna Dermenchyan**

**Description:** If you're interested in advocating for nursing at the policy level, then this is the session for you! Come discuss concrete steps you can take to activate and formalize your role in leadership advocacy planning.

**006 • Caring Matters Most: The Ethical Significance of Cancer Nursing**

ROOM TBA • **Mark Lazenby**

**Description:** What are the moral habits of cancer nurses? How do these habits relate to a principalist or ethics of caring approach to ethics? Join the group in a session designed to stimulate conversation about the habits of a moral nurse within the context of cancer nursing.

**018 • Developing a Moral Distress Consultation Service**

ROOM TBA • **Ann Hamric**

**Description:** Come meet with one of the leaders in the work to identify and address moral distress in this session designed to explore moral distress consultation. Take time to consider how you can implement this valuable service in your institution.

**019 • Is that Ethical?—What does the public think and Why Does it Matter?**

ROOM TBA • **Christine Mitchell**

**Description:** Public opinion matters. Come join this lively conversation about why and how to involve the public in discussions designed to address ethical concerns relevant to nursing. Education, policy, and community issues will be explored as they relate to empowering voices and ensuring impact.

**010 • Clinical Ethics Dilemmas in Pediatrics: Why These Cases May Haunt You**

ROOM TBA • **Lucia Wocial**

**Description:** Pediatric cases can be particularly challenging for nurses. Join us as we explore essential ethical concepts and describe a practical approach to addressing these multifaceted cases. We'll also explore the value of narrative inquiry when facing these dilemmas.

3:15-3:45

**Break • Refreshments Served • Centennial Hall • 1st floor**

**Poster viewing • Pinnacle, Odyssey, Pathways, and Innovation • 1st Floor**

3:45-4:45

**020 • Closing: Aspiring to Care Utopias:  
The Role of Ethical Competence and Competent Ethics**

**Centennial Ballroom**

**Ann Gallagher**

**Description:** Critical discussions about ethical competence are needed to consider the implications of ethical competence in relation to care. This session will provide you a new lens through which to consider the pathways to care utopias.

4:45-5:00

**Evaluations and Closing Comments • Centennial Ballroom**

**021 • Poster Sessions • Regularly scheduled throughout the conference**

**Pinnacle, Odyssey, Pathways, and Innovation • 1st Floor**

**Description:** Join your colleagues as they share their work with us in these interactive poster sessions.

